

GW3015VS

ASME B1.1

DC



CHARACTERISTICS



Technical drawing

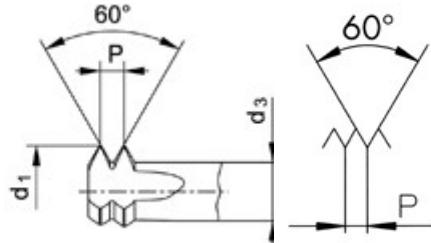
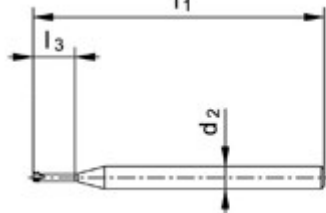

Profile sketch

Tool data

ID	D1	Ø d1	P	l1	l2	l3	d2		
206423	UNC2-56	1.66	0.454	39.0	0.9	5	3.00	3	1.75

Product range GW3015VS UNC2-56

ID	D1	Ø d1	P	l1	l2	l3	d2		
206423	UNC2-56	1.66	0.454	39.0	0.9	5	3.00	3	1.75
206424	UNC3-48	1.91	0.529	39.0	1.1	5.8	3.00	3	2.00
206425	UNC4-40	2.11	0.635	39.0	1.3	6.6	3.00	3	2.25
206426	UNC5-40	2.44	0.635	51.0	1.3	7.5	5.00	4	2.55
206427	UNC6-32	2.59	0.794	51.0	1.6	8.5	5.00	4	2.75
206428	UNC8-32	3.25	0.794	51.0	1.6	9.8	5.00	4	3.40
206429	UNC10-24	3.60	1.058	51.0	2.1	11.6	5.00	4	3.80
206430	UNC12-24	4.27	1.058	51.0	2.1	12.9	5.00	4	4.40
206431	UNC1/4-20	4.89	1.270	51.0	2.5	15	5.00	4	5.10